

- NOTES:**
- WHEN INSTALLING PROPOSED WASTEWATER SEWERS ON LEILA AVE TAKE CAUTION WHEN CROSSING EXISTING RESIDENTIAL WATER SERVICES.
 - CONTRACTOR SHALL VERIFY ELEVATION OF EXISTING SEWER SERVICES AT PROPOSED DOWNSTREAM CONNECTION LOCATIONS PRIOR TO INSTALLATION OF COLLECTOR WWS TO ALLOW FOR CHANGES OF GRADE TO THE COLLECTOR WWS.
 - WHEN CROSSING THE NEW WWS TRUNK ON LEILA AVE WITH NEW WWS SERVICES (ALL SOUTH WWS SERVICES BETWEEN SALTER ST. AND AIKINS ST.) TO CONNECT TO THE COLLECTOR WWS, TAKE CAUTION NOT TO CROSS SHAFT LOCATIONS FOR THE NEW WWS TRUNK TO MITIGATE THE RISK OF POTENTIAL SERVICES SETTLEMENT.

SEWER SERVICE INFORMATION					
ADDRESS	STATUS	SIZE (mm) MATERIAL	COORDINATES AT JUNCTION	COORDINATES AT PROPERTY	REMARKS
#300 LEILA AVE	ACTIVE	250 UNKNOWN	N=5534092.22 E=635006.88	N=5534083.83 E=635001.79	NONE
#301 LEILA AVE	ACTIVE	150 UNKNOWN	N=5534094.23 E=635002.58	N=5534109.09 E=635006.55	NONE
#300 LEILA AVE	UNKNOWN	150 UNKNOWN	N=5534098.16 E=634994.54	UNKNOWN	NONE
#305 LEILA AVE	ACTIVE	150 UNKNOWN	N=5534108.17 E=634980.32	UNKNOWN	NONE
#309 LEILA AVE	ABAND	150 UNKNOWN	N=5534113.85 E=634966.70	UNKNOWN	NONE
#310 LEILA AVE	ACTIVE	150 UNKNOWN	N=5534119.55 E=634953.25	UNKNOWN	NONE
#313 LEILA AVE	UNKNOWN	150 UNKNOWN	N=5534120.27 E=634951.54	UNKNOWN	NONE
#310 LEILA AVE	ABAND	150 UNKNOWN	N=5534123.86 E=634943.08	UNKNOWN	NONE
#317 LEILA AVE	ACTIVE	150 UNKNOWN	N=5534125.31 E=634939.66	UNKNOWN	NONE
#310 LEILA AVE	UNKNOWN	150 UNKNOWN	N=5534130.31 E=634927.86	UNKNOWN	NONE
#321 LEILA AVE	ACTIVE	150 UNKNOWN	N=5534132.50 E=634922.69	UNKNOWN	NONE

SEWER JUNCTION INFORMATION FROM SEWER VIDEO INSPECTION SEWER ID S-MA00001530		
DISTANCE FROM MH ID S-MH00001281	DIAMETER	CLOCK
10.7	150	2
23.7	250	9
25.4	150	2
36.4	150	10
38.2	150	1
40.0	150	11
41.9	150	1
51.1	150	10
54.8	150	1
67.6	150	10
73.2	150	2

SEWER JUNCTION INFORMATION FROM SEWER VIDEO INSPECTION SEWER ID S-MA00000720		
DISTANCE FROM MH ID S-MH00001284	DIAMETER	CLOCK
12.8	150	2
13.8	150	11
13.8	150	1
21.7	150	11
26.5	250	2



ENGINEER'S SEAL
 ORIGINAL DRAWING SEALED BY:
 M.A. IANKOVA-DEDOVA
 2026/03/11
 CONSULTANT DRAWING NUMBER
 C1-23

THE CITY OF WINNIPEG
 WATER AND WASTE DEPARTMENT
 ENGINEERING SERVICES DIVISION

ARMSTRONG SEWER RELIEF WORKS
 CONTRACT 1
LEILA AVENUE
 13.1 E OF SALTER STREET TO
 113.1 E OF SALTER STREET

SHEET **23** OF **46**
 CITY DRAWING NUMBER
13664

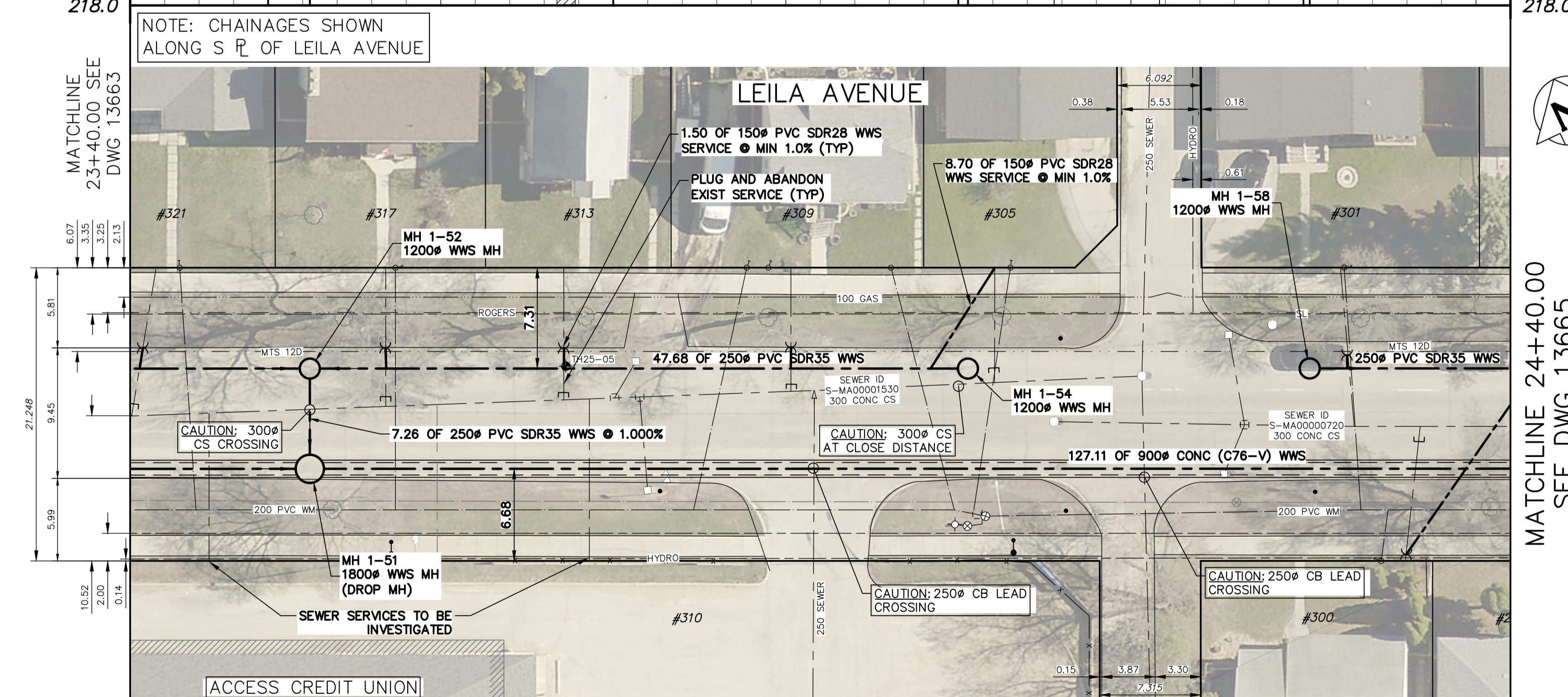

FOR INDEX PAGE
 SEE DWG 13643

METRIC
 WHOLE NUMBERS INDICATE MILLIMETRES
 DECIMALIZED NUMBERS INDICATE METRES

SCALE 1:250 (A1)

WARNING
 IF POWER EQUIPMENT OR EXPLOSIVES ARE TO BE USED FOR EXCAVATION ON THIS PROJECT THE CONTRACTOR MUST:
 1) NOTIFY THE GAS COMPANY OF THE PROPOSED LOCATION OF EXCAVATION.
 2) TAKE PRECAUTION TO AVOID DAMAGE TO GAS COMPANY INSTALLATIONS.
 SEE PROVINCIAL REGULATION 210/72 FOR DETAILS

LOCATION APPROVED
 UNDERGROUND STRUCTURES

SUPV. U/G STRUCTURES COMMITTEE DATE

NOTE:
 LOCATION OF UNDERGROUND STRUCTURES AS SHOWN ARE BASED ON THE BEST INFORMATION AVAILABLE BUT NO GUARANTEE IS GIVEN THAT ALL EXISTING UTILITIES ARE SHOWN OR THAT THE GIVEN LOCATIONS ARE EXACT. CONFIRMATION OF EXISTENCE AND EXACT LOCATION OF ALL SERVICES MUST BE OBTAINED FROM THE INDIVIDUAL UTILITIES BEFORE PROCEEDING WITH CONSTRUCTION.

VERTICAL DATUM: CGVD28 (HT2.0 Geoid)
 HORIZONTAL DATUM: NAD83 (June 1990), Zone 14

NO.	ISSUED FOR CONSTRUCTION	DATE (YYYY/MM/DD)	MID	BY
0	ISSUED FOR CONSTRUCTION	2026/03/10	MID	

KGS GROUP

DESIGNED BY	MID	CHECKED BY	TLE
DRAWN BY	GEL	APPROVED BY	RBO
SCALE:		RELEASED FOR CONSTRUCTION	
HORIZONTAL: 1:250		DUANE BAKER	
VERTICAL: 1:50		DATE	2026/03/12